

Soils Map

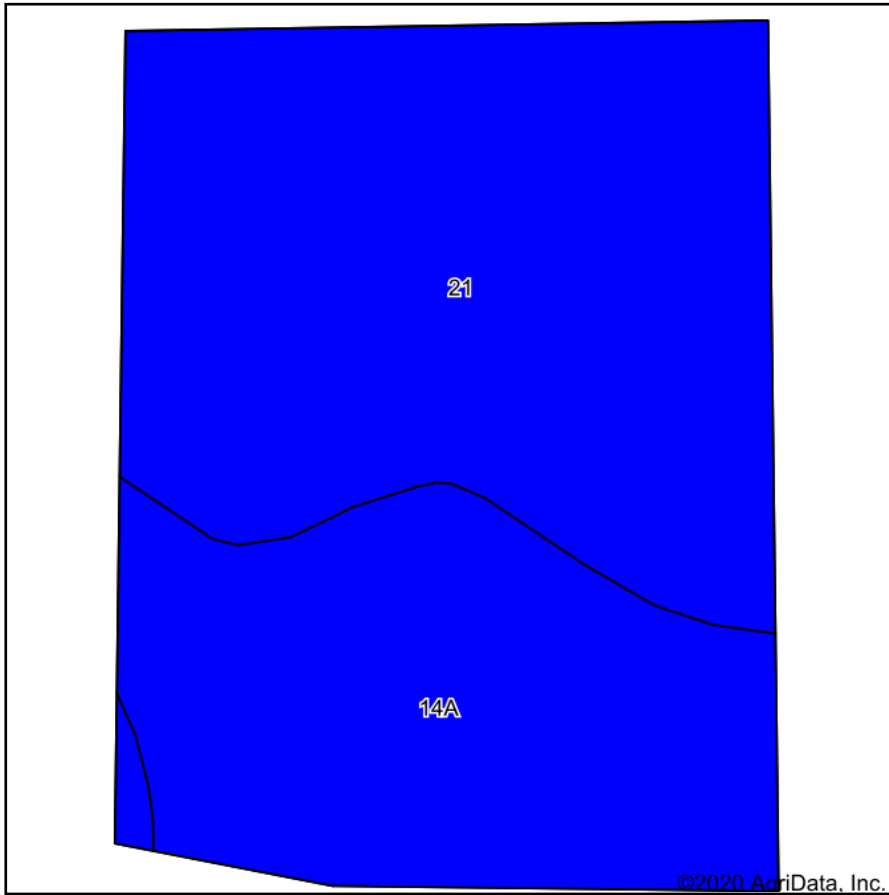

Soils data provided by USDA and NRCS.

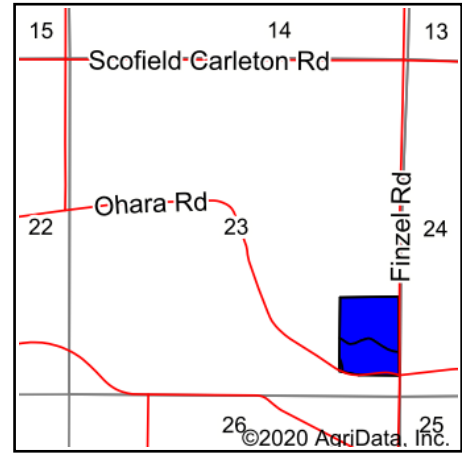

State: **Michigan**
 County: **Monroe**
 Location: **24-5S-8E**
 Township: **Exeter**
 Acres: **26.73**
 Date: **11/20/2020**

Maps Provided By:

 CUSTOMIZED ONLINE MAPPING
 © AgriData, Inc. 2020 www.AgriDataInc.com



Code	Soil Description	Acres	Percent of field	Non-Irr Class Legend	Non-Irr Class *c	Bromegrass alfalfa	Corn	Legume hay	Oats	Orchardgrass alfalfa hay	Soybeans	Sugar beets	Winter wheat	*n NCCPI Overall	*n NCCPI Corn	*n NCCPI Small Grains	*n NCCPI Soybeans
21	Lenawee silty clay loam, 0 to 1 percent slopes	16.26	60.8%		Ilw		120	4.7	84		39.9	19.8	45	67	67	42	
14A	Del Rey silt loam, 0 to 3 percent slopes	10.47	39.2%		Ilw	7.5	115		69	4.5	37		49	64	61	47	
Weighted Average							2.9	118	2.9	78.1	1.8	38.8	12	46.6	*n 65.8	*n 64.6	*n 44

*n: The aggregation method is "Weighted Average using all components"

*c: Using Capabilities Class Dominant Condition Aggregation Method

Soils data provided by USDA and NRCS.